

# Dairy Mat and Roll Installation Procedures

## 1. Introduction

Red Barn is manufactured from 100% vulcanized rubber into square sheets or rolled goods. The slip-resistant product is very durable and provides a non-porous, safe, comfortable flooring system.

- Available in a standard square mat or in an interlocked format which is pinned down.
- Available also as a rolled product, up to 150' rolls.
- Red Barn has a nylon insert to reduce stretching and increase tensile strength.
- Manufactured of high quality materials and carefully inspected before shipment, however, a quality installation is the responsibility of the installer. The installer needs to verify the accuracy of the order, and materials need to be inspected for damage and defects prior to installation.

**An authorized Red Barn distributor shall be notified of any damages or product irregularities prior to installation.**

**Red Barn is not recommended for environments where the product will be exposed to oils or petroleum based materials.**

## 2. Handling & Storage of Materials

Receive mats in a careful manner to avoid any damage. Prevent damage or contamination to materials by freezing, excessive heat, foreign matter or other causes.



**Rubber mats are susceptible to dimensional changes due to temperature and climate conditions. It is vital that site conditions remain constant within the acceptable working range of the installation area which is  $\pm 10^{\circ}\text{C}$  of the average local temperature.**

## 3. Cutting Red Barn Mats



Red Barn mats can be cut with a utility knife using a straight edge or square as a guide. Round holes can be cut using a hole saw or fine tooth jigsaw.

## 4. Installation Materials

### a) Red Barn mat

### b) Tools

- Sharp utility knife & spare blades
- Hole saw or fine tooth jigsaw
- Carpenter square & straight edge
- Measuring tape
- Chalk line (for layout)
- Markers (to indicate cut lines)
- Cut-resistant gloves
- Safety glasses
- Drill
- 2 1/2" concrete pins
- 1" washers
- Hammer

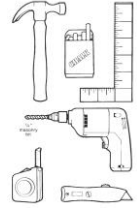

## 5. Sub-Floor Preparation

The installation of any resilient rubber flooring is only as good as the sub-floor it is laid upon. Rough and uneven sub-floors can diminish the appearance, cause uneven top surfaces and shorten the life span of such flooring. We therefore recommend proper preparation of such sub-floors as follows:

### Concrete Floors

- Minimum 10 cm thick
- No holes
- Level off uneven areas
- Ensure existing concrete floors are clean and smooth.
- Repair any low spots with a cementitious based latex patch mix.
- Fill and smooth any rough or porous concrete sub-base prior to installing flooring.

## 6. Installing Red Barn Interlocking Mats

Before work commences, examine the areas to be covered and repair.

Dry lay the entire floor including cutting and trimming prior to pinning. Offsetting the interlock to avoid a 4 corner match will increase the hold of the interlock

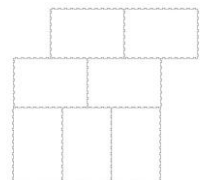

# Red Barn Mat and Roll Installation Manual

- Put mats together loosely, lift them a little bit and pull slightly apart.
- At low temperatures pull the puzzle seams so far apart that an opening becomes visible to allow for expansion and contraction.



## Cut mats to fit

- At the beginning and end of an area, the excess puzzle edges can be cut off.
- Cut mats neatly around fixed objects, and to fit irregular and fill-in spaces using a sharp utility knife. Make repeated passes when cutting to ensure straight cuts.



***It is the installer's responsibility to inspect the dry laid installation and notify the appropriate authority of any imperfections or irregularities prior to final installation.***

## Fasten the mats to the concrete with pins and washers

- On slopes or with large areas the mats should be interlocked and pinned.
- Drill a hole into the mat and the concrete.
- Pin the mats along the perimeter approximately every 16"-22" apart using 10-12 pins per mat.
- In a small area, the interlock should be adequate to hold the mats
- Recess the pin so it is level with the top of the mat.



## 7. Installing Red Barn Rolled Matting

***Actual performance will vary depending upon 1) use, 2) moisture, 3) percent of pre-stretch, 4) variation in temperature. The material should lay flat for over 5 years under normal conditions.***

### Stretch and Hold Method

- Allow the material to come to normal room temperature ( $\pm 64^{\circ}\text{F}$  or  $\pm 18^{\circ}\text{C}$ ) prior to this installation method.
- Unroll material in the alley and pin the leading (uphill end or the end where the manure scrapping starts) with  $2\frac{1}{2}$ " concrete pins and 1" washers. Place a pin every 8" – 10". More pins may be required if the slope is severe.
- Stretch material up to .05% and pin as per above.

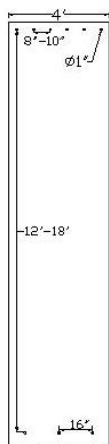

### Let it Ride Method

- Unroll material in the alley and pin the leading (uphill end or the end where the manure scrapping starts) with  $2\frac{1}{2}$ " concrete pins and 1" washers. Place a pin every 8" – 10"
- If necessary retain the material from moving sideways with a strip of  $\frac{1}{2}$ " plastic or other suitable material. Having the material inset into the concrete is ideal. Leave half ( $\frac{1}{2}$ " ) inch for every 4 feet of width for sideways movement.
- If the barn alley is longer than one roll length, allow room between the rolls for the material to stretch. Cut off excess material when necessary. The material will stretch more in the first year than in subsequent years.



- In the event of sand in the barn, it is recommended to pin down the roll material to keep the sand from building up under the rubber and causing excess wear.

## 8. Cleaning and Maintenance

- New material may be slippery and may need to be washed down prior to use. A general purpose dairy cleaner with lower or neutral ph is recommended. To remove mold release left over from the manufacturing process. Or, sprinkle sand over the rubber for the first period until the mold release is worn off.

### Precautions:

- Red Barn matting must not be cleaned with any petroleum based cleaners. If any petroleum product is spilled on the matting, it should be removed immediately to avoid damage to the matting and voiding of warranty.

## 9. Disclaimer

- This procedure is a guideline which may be used to produce an effective finished installation and should be reviewed in the context of the installation site(s).
- **North West Rubber Ltd., (NWR)** does not warrant any installation work not directly performed by **NWR**, and specifically disclaims liability for any direct or indirect personal injury, property damage or other costs or losses resulting from installations or applications by third parties. Please see the **NWR**, Limited Warranty for the particulars of warranty coverage relating to **NWR**, products.